

## Swimming pool Light

# 4.1900

- Protection class IP68 – for a water depth of up to 3 m
- Spotlight housing entirely made of stainless steel 316Ti 1.4571

...

- POW-LED cold white, warm white, neutral white
- Multichip POW-LED RGB-W
- Operating mode mono: constant voltage
- Operating mode RGB-W: constant current
- Temperature controlled (onboard); surge protection
- Light distribution especially for swimming pool lighting „asymmetric Mixflux“

...

- For leisure pools and sports pools with walkaround or surrounding shaft
- Wall installation in all standard pool types
- Incl. end cover with integrated access port
- Constant-voltage power source/RGB-W controller ordered separately
- Supplied with 2 m of special underwater cable

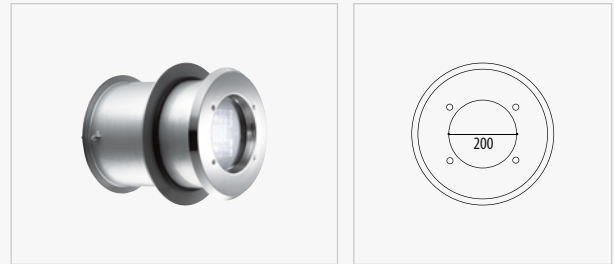

IP68	STAINLESS STEEL V4A 1.4571 316Ti	POW-LED INCL.	3.000 K 4.500 K 6.000 K RGB-W	CONSTANT CURRENT CONSTANT VOLTAGE	CABLE INCL.	max 3m	←
	CE						

### [00] Tiled concrete pools (tiles+mortar 15–20 mm)

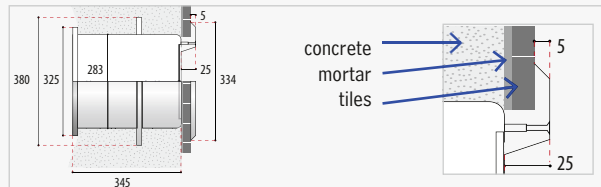

### [04] Stainless steel pools (welded flange)



### [01] Concrete pools with fitted foil (pressure flange)

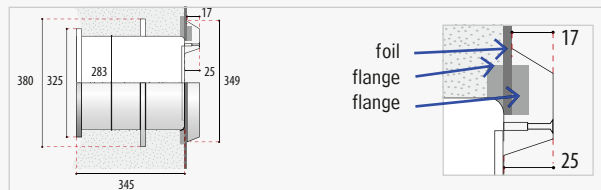

### [50] Tiled pools with movable floors (tiles+mortar 16–20 mm)

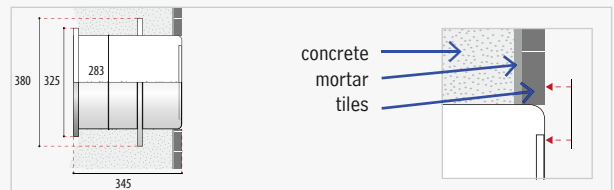

### [03] Pools with adhesive/foil coatings (adhesive flange)

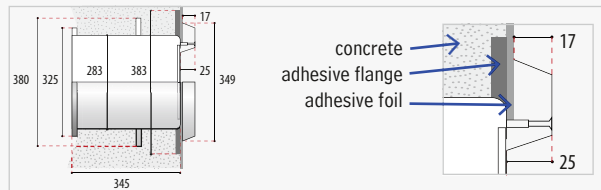

### [60] later installation (tiles + mortar 15–20 mm)

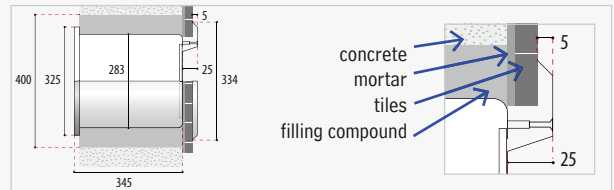

housing extension  
per each 380 mm  
**9.1920.00.00**

housing shorten  
minimal 280 mm  
**9.1921.00.00**

Customer-specific  
installations and  
special designs  
available on request.

## Underwater environments only

## Monochrome and dynamic illumination

#	Color	Lumen	LED	Watt	Power	Beam	Cable	Connect → 208
4.1903. [ ] .11	6000K cold white	9300 lm	16 POW-LED	total 62 W	CV 12 V-DC	asymmetric Mixflux	UW, 5x1,5 qmm	5.0630.20.16 max 1
4.1903. [ ] .12	3000K warm white	7520 lm						
4.1903. [ ] .13	4500K neutral white	8040 lm						
4.1903. [ ] .41	RGB-CW cold white 6000K	cold white: 2320 lm	16 Multichip POW-LED	all on 76 W	CC 12 V-DC		UW, 25x0,5 qmm	5.0670.39.52 max 1
4.1903. [ ] .42	RGB-VW warm white 3000K	warm white: 1880 lm						
4.1903. [ ] .43	RGB-NW neutral white 4500K	neutral white: 2010 lm						

[ ] Complete the article number with the code of the installation variant